



SBI INFRA MANAGEMENT SOLUTIONS PVT. LTD.
STATE BANK OF INDIA, CIRCLE OFFICE KOLKATA,
SAMMRIDDHI BHAWAN, 1, STRAND ROAD,
KOLKATA-700 001

**SBIIMS INVITE ONLINE E-TENDERS FOLLOWED BY
E-REVERSE AUCTION
ON BEHALF OF SBI**

**FOR
INTERIOR FURNISHING & ALLIED CIVIL WORK FOR REDESIGNING & RENOVATION
OF
SBI OVERSEAS BRANCH (1ST FLOOR)
AT BLOCK A OF SAMRIDHDHI BHAWAN**

**THE SBI KOLKATA CIRCLE APPROVED CONTRACTORS
EMPANELLED ON FOLLOWING CATEGORY ONLY ARE ELLIGIBLE.**

- 1. INTERIOR FURNISHING & ALLIED CIVIL
[CATEGORY- 2(C)]/SBI/LHO/KOLKATA/2017**

TENDER ID: KOL201905017

NOTE: PLEASE SUBMIT TENDER APPLICATION FEE (TDC) THROUGH **ONLINE MODE ONLY AS MENTIONED IN 2ND PAGE OF THIS NIT. TDC IN FORM OF DD WILL NOT BE ACCEPTED. SUCH TENDERS WITH-OUT ONLINE PAYMENT RECEIPT WILL BE REJECTED.**

END DATE FOR TENDER DOCUMENT SUBMISSION: **UPTO 3.00 P.M OF 11.06.2019**

SBI INFRA MANAGEMENT SOLUTIONS PVT.LTD
CIRCLE OFFICE,KOLKATA

E-TENDER NOTICE

SBI Infra Management Solutions Pvt Ltd (SBIIMSPL) Invites Electronically Sealed **Item Rate** E-Tenders In Followed By E-Reverse Auction In Two Cover Electronic System From The Bank's Empanelled Interior Contractors In [**Category 2-(C)**] For Interior Furnishing And Allied Civil Works For Redesigning Of **Sbi Overseas Branch (1st Floor)** Under Kolkata Circle Through Online E-Tender Portal: <https://Etender.Sbi>

DETAILS OF TENDERS ARE AS UNDER:

1.	Name Of Work	:	INTERIOR FURNISHING AND ALLIED CIVIL WORKS FOR REDESIGNING OF SBI OVERSEAS BRANCH (1ST FLOOR) AT GR. FLOOR OF SBI SAMRIDDHI BHAWAN
2.	Tenders Shall Remain Valid For	:	90 Days From The Date Of Opening Of Tenders.
3.	Time Of Completion Of Work	:	60 Days From The Date Of Issue Of Work Order.
4.	Estimated Cost	:	Rs 33.95 Lakh (Rupees Thirty Three Lacs Ninety Five Thousand Only) This Amount Is Exclusive Of Applicable Goods & Services Tax (Gst), Which Shall Be Paid Extra As Applicable On Final Bill.
5.	Earnest Money Deposit	:	Rs. 34,000.00 (Rupees Twenty Four Thousand Only). By Means Of Demand Draft / Pay Order (To Be Deposited At The Office Of Sbiimspl, Circle Office, Kolkata In Favor Of Sbi Infra Management Solutions Pvt. Ltd) Under Sealed Envelope.
6.	Cost Of Tender Documents (Application Fee)	:	Rs. 3,000/- (Rupees Three Thousand Only) (To Be Deposited At The Office Of Sbiimspl, Circle Office, Kolkata In Favor Of SBI INFRA MANAGEMENT SOLUTIONS PVT. LTD.) Under Sealed Envelope. Note: Please Submit Tender Application Fee (Tdc) Through Online Mode Only As Mentioned In This Nit. Tdc In Form Of Dd Will Not Be Accepted. Such Tenders With-Out Online Payment Receipt Will Be Rejected.
7.	Availability Of Tender Documents	:	Tender Documents To Be Downloaded From The Bank's Website Or Sbi E-Tender Portal https://Etender.Sbi
8.	Tender Document Downloading Start Date	:	From 11:00 A.M On 31.05.2019
9.	Tender Document Downloading End Date	:	Upto 3.00 P.M On 11.06.2019
10.	Last Date And Time Of Submission Of Tenders	:	Upto 3.00 P.M On 11.06.2019
11.	Date And Time Of Start Of E-Reverse Auction (E-Ra)	:	<u>To Be Intimated In Due Course To The Technically Qualified Bidders Only.</u>
	Start Bid Price And Minimum Decrement Value For E-Ra. (Bidders Will Need To Quote On The Total Cost Of Project During E-Reverse Auction)	:	Start Bid Price And Minimum Decrement Value Will Be Announced At The Time Of E-Ra.
	Duration Of E-Reverse Auction	:	60 Minutes + 6 Extensions Of 05 Minutes Each; Total Time: 60 + 30 Minutes = 90 Minutes

			(Please Note, If No Bids Are Received During Any Extension, The E-Reverse Auction Will Terminate At That Very Extension.)
	Methodology For Evaluating Item Rate And Total Amount Of L1 Bidder After E-Reverse Auction All Tender Participants Are Hereby Requested To Note That The Quoted Amount By The L-1 Bidder In E-Reverse Auction Will Be Considered By Bank Considering Lowest Of Following Two Values: 1. Amount Quoted In Reverse Auction By The Bidder 2. Amount Quoted By The Same Bidder In The Price Bid Before Reverse Auction	:	Price Bids (Indicative Bids) Submitted By The Contractors Shall Be Kept Sealed Till The Event Of E-Reverse Auction. At The End Of Reverse Auction Process, The Lowest Bidder (L1) Will Be Selected On The Basis Of Total Price, Including Taxes But Excluding Applicable Gst. The Item Wise Final Price To Be Confirmed By The Vendor Shall Be As Under: Final Item Rate = K*(R) Sl. Rate Qty. Amount (K*R*Qty.) 1. Rs. 200 X 0.9 600 Rs. 108000/- 2. Rs. 250 X 0.9 700 Rs. 157500/- 3. Rs. 300x 0.9 200 Rs. 54000/-, Etc. Total Amount Worked Out After E-Reverse Auction Will Be The Sum Of All Items' Amounts Of Work Schedule Calculated As Above.
12	Defects Liability Period	:	12 Months From The Date Of Virtual Completion Of Work
13	For E-Tender Related Queries	:	Service Provider: M/S. E-Procurement Technologies Limited (Abc Procurement/ Auction Tiger) B-705, Wall Street- li, Opp. Orient Club, Ellis Bridge, Near Gujarat College, Ahmedabad- 380006, Gujarat Help Desk: (Mon-Fri Working Hours 10 Am To 7 Pm) (Sat Working Hours 10am To 4pm)
14	Documents Required To Be Submitted With Technical Bid At Sbiims Circle Office		1. Emd As Prescribed 2. Tender Document Cost As Prescribed 3. Empanelment Letter Of Sbi 4. Process Compliance Statement As Per Annexure-I Of Nit 5. 1st Page Of This Nit Duly Signed By Vendor
15	Corrigendum:		(If Any) Is To Be Followed As Published In https://Etender.Sbi Portal Only.
	Notes:		
A)	All Contractors Who Are Em-Paneled With Sbi Bengal Circle In The Specific Category Are Only Eligible For The Above Mentioned Work.		
B)	Any Abnormal Increase From The Quoted Price / Cost Will Not Be Acceptable.		
C)	The Bank Reserves The Right To Reject Any Or All The Tenders Without Assigning Any Reason.		
D)	If The L1 Bidder Quotes Abnormally Low (Below 15% Of The Estimated Cost), He Will Be Required To Furnish A Performance Guarantee Bond And Additional Security Deposit Amounting To The Difference Between Estimated And Quoted Amount Which Will Be Released After Successful Completion Of Defect Liability Period.		
E)	Electronically Sealed E-Tenders Are Invited From The Bank's Empanelled Contractors Having Experience In The Specific Category In Two Parts, I.E. Cover – I And Cover –II Separately Sealed Tenders In Two Parts I.E.		

	<p>Cover-I And Cover- II Are To Be Submitted Online On The Website https://Etender.Sbi ** No Bid Shall Be Accepted Offline.</p> <p>(A)Part – I (Technical Bid + Emd): Technical Bid Already Available In Of-Line Mode & Emd As Stated Above.</p> <p>(B) Part – II (Price Bid): This Shall Contain The Electronic Format Of Price Bid. No Condition/ Stipulation In This Part Other Than Unconditional General Rebate Shall Be Accepted.</p> <p>Part – II (Price Bid) Of Those Bidders Will Be Opened Who Would Be L1 In The E-Reverse Auction Process. The Contractors Can View The Tender Opening Details Through Their Respective Log-In Ids On The Above Mentioned E-Tender Portal (Website).</p>
F)	The Bidder Is Expected To Examine All Instructions, Forms, Terms And Specifications In The Bid Documents. Failure To Furnish All Information Required As Per The Bid Documents Or Submission Of Bids Not Substantially Responsive To The Bid Documents In Every Respect Will Be At The Bidder's Risk And Shall Result In Rejection Of The Bid.
G)	In Case The Date Of Opening Of Tenders Is Declared As A Holiday, The Tenders Will Be Opened On The Next Working Day At The Same Time.
H)	The Bank Reserves The Right To Reject All Tenders Without Assigning Any Reason Whatsoever.
	<u>E-Tendering Instructions To Bidders</u>
	<p>General</p> <p>State Bank Of India Hereby Publish The Tender On E-Tendering Portal (Website) https://Etender.Sbi In Electronic Mode Hereinafter Referred As "E Tendering" And Tender Will Be Hereunder Called As "E-Tender". The E-Tender Published Online Through Above Portal (Website) Consisting Of Standard Tender Conditions, Specifications, Schedule Of Quantities, Drawings (If Any) For Above Referred Work. Please Note That Copy Of The Above E-Tender Can Be Downloaded From Above Portal (Website) And Should Be Mandatorily Submitted In Online Electronic Mode Hereinafter Referred As "Online Offer". The Submission Of Online Offer Duly Encrypted & Digitally Signed On Above Portal Should Be In Prescribed Electronic Forms (Online) Available On Above Portal For Respective Tender In Online Envelope(S) On Or Before As Per The Key Dates Mentioned In The Tender Notice In This Document And Online Portal For Above Tender .</p> <p>Instructions</p> <p>1. Tender Bidding Methodology:</p> <p>Electronically Sealed Bid System – One Stage - Two Envelopes', 2nd Stage- Opening Of Financial-Part.</p> <p>2. Broad Outline Of Activities From Bidders Prospective:</p> <ol style="list-style-type: none"> 1. Procure A Digital Signing Certificate (Dsc) 2. Register On The E-Procurement Portal https://Etender.Sbi (The Contractors Need To Upload Scan Copy Of Their Valid Empanelment Letter In The Portal Otherwise Their Registration Would Be Cancelled) 3. Create Users And Assign Roles On The Above Portal 4. View Notice Inviting Tender (Nit) On The Above Portal 5. Download Official Copy Of Tender Documents From The Above Portal 6. Clarification To Tender Documents On The Above Portal 7. Bid-Submission On The Above Portal 8. Attend Public/Limited Online Tender Opening Event (Toe) On The Above Portal – Opening Of Technical-Part 9. Post-Toe Clarification On The Above Portal (Optional) – Respond To Sbi's Post-Toe Queries 10. Attend Public/Limited Online Tender Opening Event (Toe) On The Above Portal – Opening Of Financial-Part (Only For Technical Responsive Bidders) 11. Participate In E- On The Above Portal

For Participating In This Tender Online, The Following Instructions Are To Be Read Carefully. These Instructions Are Supplemented With More Detailed Guidelines On The Relevant Screens Of The Above Portal.

3. Digital Certificates

For Integrity Of Data And Authenticity/ Non-Repudiation Of Electronic Records, And To Be Complaint With It Act 2000, It Is Necessary For Each User To Have A Digital Certificate (Dc). Also Referred To As Digital Signature Certificate (Dsc), Of Class Ii Or Above, Issued By A Certifying Authority (Ca) Licensed By Controller Of Certifying Authorities (Cca) [Refer [Http://Www.Cca.Gov.In](http://www.cca.gov.in)].

4. Registration

To Use The Electronic Tender Portal [Https://Etender.Sbi](https://Etender.Sbi), Vendors Need To Register On The Portal. Registration Of Each Organization Is To Be Done By One Of Its Senior Persons Vis-A-Vis Authorised Signatory Who Will Be The Main Person Coordinating For The E-Tendering Activities. In The Above Portal Terminology, This Person Will Be Referred To As The Super User (Su) Of That Organization. For Further Details, Please Visit The Website/Portal, And Follow Further Instructions As Given On The Site.

Note: After Successful Submission Of Registration Details Please Contact To The Helpdesk Of The Portal To Get Your Registration Accepted/Activated.

Help Desk:

Contact Person Darshik Pathak | Web: [Www.Procuretiger.Com](http://www.Procuretiger.Com)

M: 91-9879996111 | T: 079- 68136889 Email: Darshik@Procuretiger.Com

5. Bidding Related Information For This Tender (Sealed Bid)

The Entire Bid-Submission Would Be Online On The Portal. Broad Outline Of Submissions Are As Follows:

- Submission Of Bid Security/ Earnest Money Deposit (Emd) & Cost Of Bid Document
- Submission Of Digitally Signed Copy Of Tender Documents/ Addendum
- Power Of Attorney
- Two Envelopes
 - Technical-Part
 - Financial-Part

Each Of The Above Electronic Envelopes Consists Of Main Bid And Electronic Form (Both Mandatory) And Bid Annexure (Optional).

Note: Please Note That Above E-Tendering System Is An Automatically Time Locked System Which Will Be Locked Immediately As Soon As Due Date And Time Is Over And Will Not Accept Any Offer After That. So, The Tenderers Are Strictly Advised To Do Their Process Well Before The Due Date And Time To Avoid Any Such Instances.

6. Tender Opening Event (Toe)

The E-Procurement Portal Offers A Unique Facility For 'Public/Limited Online Tender Opening Event (Toe)'. Tender Opening Officers As Well As Authorized Representatives Of Bidders Can Attend The Public/Limited Online Tender Opening Event (Toe) From The Comfort Of Their Offices. For This Purpose, Representatives Of Bidders (I.E. Supplier Organization) Dully Authorized Are Requested To Carry A Laptop And Wireless Connectivity To Internet. Every Legal Requirement For A Transparent And Secure 'Public/Limited Online Tender Opening Event (Toe)' Has Been Implemented On The Portal. As Soon As A Bid Is Decrypted With The Corresponding 'Pass-Phrase' As Submitted Online By The Bidder Himself (During The Toe Itself), Salient Points Of The Bids Are Simultaneously Made Available For Downloading By All Participating Bidders. The Tedium Of Taking Notes During A Manual 'Tender Opening Event' Is Therefore Replaced With This Superior And Convenient Form Of 'Public/Limited Online Tender Opening Event (Toe)'. The Portal Has A Unique Facility Of 'Online Comparison Chart' Which Is Dynamically Updated As Each Online Bid Is Opened. The Format Of The Chart Is Based On Inputs Provided By The Buyer For Each Tender. The Information In The Comparison Chart Is Based On The Data Submitted By The Bidders. A Detailed Technical And/ Or Financial Comparison Chart Enhance Transparency. Detailed Instructions Are Given On Relevant Screens. The Portal Has A Unique Facility Of A Detailed Report Titled 'Minutes Of Online Tender Opening Event (Toe)' Covering All Important Activities

Of 'Online Tender Opening Event (Toe)'. This Is Available To All Participating Bidders For'Viewing/ Downloading'. There Are Many More Facilities And Features On The Portal. For A Particular Tender, The Screens Viewed By A Supplier Will Depend Upon The Options Selected By The Concerned Buyer.

Important Note: In Case Of Internet Related Problem At A Bidder's End, Especially During 'Critical Events' Such As – A Short Period Before Bid-Submission Deadline, During Online Public/Limited Tender Opening Event, It Is The Bidder's Responsibility To Have Backup Internet Connections. In Case There Is A Problem At The E-Procurement/ E-auction Service-Provider's End (In The Server, Leased Line, Etc) Due To Which All The Bidders Face A Problem During Critical Events, And This Is Brought To The Notice Of Sbiims By The Bidders In Time, Then Sbiims Will Promptly Re-Schedule The Affected Event(S).

7. Minimum Requirements At Bidders End

In Order To Operate On The Electronic Tender Management System, The User's Machine Is Required To Be Set Up. The Machine Must Have Running Xp Service Pack 3 Or Higher Version Of Windows Like Vista Or Window

7. Also Need To Install Mozilla Fire Fox Web Browser And Latest Version Of Java.

Process Compliance Statement (Annexure I)

(The Bidders Are Required To Print This On Their Company's Letter Head And Sign, Stamp And Submit With Technical Bid)

To,

M/S. E-Procurement Technologies Limited

Email Id:

Phone No:

Agreement To The Process Related Terms And Conditions For The Online E-Tendering Followed By E-Reverse Auction For Interior Furnishing And Allied Civil Works For Redesigning Of Sbi Overseas Branch At First Floor Of Sbi Sambriddhi Bhawan

This Has Reference To The Terms & Conditions For The E-Tendering Mentioned In The Tender Document
This Letter Is To Confirm That:

- 1) The Undersigned Is Authorized Representative Of The Company.
- 2) We Have Studied The Commercial Terms And The Business Rules Governing The E- Tendering As Mentioned In Rfp Of Sbiims Pvt. Ltd. As Well As This Document And Confirm Our Agreement To Them.
- 3) We Also Confirm That We Have Taken The Training On The E-Tendering Tool And Have Understood The Functionality Of The Same Thoroughly.
- 4) We Confirm That Sbiims Pvt. Ltd. And M/S. E-Procurement Technology, Shall Not Be Liable & Responsible In Any Manner Whatsoever For My/Our Failure To Access & Bid On The E-E-Tendering Platform Due To Loss Of Internet Connectivity, Electricity Failure, Virus Attack, Problems With The Pc, Any Other Unforeseen Circumstances Etc. Before Or During The E- Tendering Event.
- 5) We Confirm That We Have A Valid Digital Signature Certificate Issued By A Valid Certifying Authority.
- 6) We, Here By Confirm That We Will Honour The Bids Placed By Us During The E-Tendering Process.

With Regards,

Date:

Signature With Company Seal Name:
Company / Organization:
Designation Within Company/ Organization:
Address Of Company/Organization:

A.General Terms And Conditions**Instructions To The Tenderers**

Sealed Tenders Are Invited By Sbiimspl For The ***Interior Furnishing And Allied Civil Works For Redesigning Of Sbi Overseas Branch***

Site And Its Location

The Above Mentioned Work Is To Be Carried Out At **Sbi Overseas Branch At 1st Floor Of Sbi Samriddhi Bhawan**

Tender Documents

The Work Has To Be Carried Out Strictly According To The Conditions Stipulated In The Tender Consisting Of The Following Documents And The Most Workmen Like Manner. *) **Instructions To Tenderers, *) General Conditions Of Contract, *) Special Conditions Of Contract, *) Additional Specifications, Drawings, *) Price Bid**

******* Important Note :**

The Above Documents Shall Be Taken As Complementary And Mutually Explanatory Of One Another But In Case Of Ambiguities Or Discrepancies, Shall Take Precedence In The Order Given Below;

A) Price Bid

B) General Terms & Conditions Of Contract

C) Instructions To Tenderers

D) Drawings

E) Special Conditions Of Contract

F) Technical Specification

The Tender Documents Are Not Transferable.**Site Visit:**

The Tenderer Must Obtain Himself On His Own Responsibility And His Own Expenses All Information And Data That May Be Required For The Purpose Of Filling This Tender Document And Enter Into A Contract For The Satisfactory Performance Of The Work. The Tenderer Is Requested Satisfy Himself Regarding The Availability Of Water, Power, Transport And Communication Facilities, The Character Quality And Quantity Of The Materials, Labour, The Law And Order Situation, Climatic Conditions Local Authorities Requirement, Traffic Regulations Etc; The Tenderer Will Be Fully Responsible For Considering The Financial Effect Of Any Or All The Factors While Submitting His Tender.

Earnest Money:

The Tenderers Are Requested To Submit The Earnest Money Of – **Rs 34,000.00 By Means Of Demand Draft / Pay Order** (Valid For A Period Of 90 Days From The Last Date Of Submission Of The Tender) From Any Scheduled Nationalized Bank Drawn **In Favor Of SBI INFRA MANAGEMENT SOLUTIONS PVT. LTD.)** .

Emd In Any Other Form Other Than As Specified Above Will Not Be Accepted. Tender Not Accompanied By The Emd In Accordance With Clause 4.1 Above Shall Be Rejected.

No Interest Will Be Paid On The EMD.

Emd Of Unsuccessful Tenderer Will Be Refunded Within 30 Days Of Award Of Contract.

Emd Of Successful Tenderer Will Be Retained As A Part Of Security Deposit.

5.0 Initial/ Security Deposit:

The Successful Tenderer Will Have To Submit A Sum Equivalent To 2% Of Accepted Tender Value Less EMD By Means Of **DD Drawn** In Favour Of **SBI Payable At Kolkata** Within A Period Of 7 Days Of Acceptance Of Tender.

Security Deposit:

Total Security Deposit Shall Be 5% Of Contract Value. Out Of This 2% Of Contract Value Is In The Form Of Initial Security Deposit (Isd) Which Includes The Emd. Balance 3% Shall Be Deducted From The Running Account Bill Of The Work At The Rate Of 10% Of The Respective Running Account Bill I.E., Deduction From Each Running Bill Account Will Be

@10% Till Total Security Deposit (Tsd) Including Isd Reaches To 5% Of Contract Value. The 50% Of The Total Security Deposit Shall Be Paid To The Contract On The Basis Of Architect's Certifying The Virtual Completion. The Balance 50% Would Be Paid To The Contractors After The Defects Liability Period As Specified In The Contract.

Additional Security Deposit: In Case L-1 Bidder Quotes Abnormally Low Rates (I.E. 15% Or More, Below Estimated Project Cost), Sbi/Im/ The Bank May Ask Such Bidder To Deposit Additional Security Deposit (Asd) Equivalent To Difference Of Estimated Cost Vis-À-Vis L-1 quoted Amount For Due Fulfilment Of Contract. Such Asd Could Be In The Joint Name Of The Bank And Bidder In The Form Of Fdr / Bank's Guarantee As Per Format Approved By The Bank. On Successful Completion Of Work Asd Will Be Returned To The Contractor. In Case Contractor Fails To Complete The Work In Time Or As Per Tender Specification Or Leave The Job Incomplete, The Bank Will Be At Liberty To Recover The Dues From Asd Or To Forfeit Such Asd As The Case May Be Within Its Sole Discretion. No Interest Shall Be Paid To The Amount Retained By The Bank As Security Deposit For The Defect Liability Period Of One Year From The Date Virtual Completion Certificate (Vcc).

However, Interest On Fdr For Additional Security Deposit Will Be Received By The Bidder.

7.0 Signing Of Contract Documents:

The Successful Tenderer Shall Be Bound To Implement The Contract By Signing An Agreement And Conditions Of Contract Attached Herewith Within 15 Days From The Receipt Of Intimation Of Acceptance Of The Tender By The Bank. However, The Written Acceptance Of The Tenders By The Bank Will Constitute A Binding Agreement Between The Bank And Successful Tenderer Whether Such Formal Agreement Is Subsequently Entered In To Or Not.

8.0 Completion Period:

Time Is Essence Of The Contract. The Work Should Be Completed In All Respect Accordance With The Terms Of Contract Within A Period Of 45 Days From The Date Of Award Of Work.

9.0 Validity Of Tender:

1. Tenders Shall Remain Valid And Open For Acceptance For A Period Of **90 Days** From The Date Of E-. If The Tenderer Withdraws His/Her Offer During The Value Period Or Makes Modifications In His/Her Original Offer Which Are Not Accurate, **Sbi Im/ Competent Authority Has The Right To Accept/Reject Any/All Tenders Without Assigning Any Reasons Whatsoever.**

Declaration

I/We Have Understood All The Above Conditions. If I/We Fail To Start/ Or Execute Work Within The Stipulated Period Of Time, Our Security Deposit Will Be Forfeited.

Place:

Date:

Signature Of Contractor

C.Instructions To The Tenderers

While Quoting For Each Item Of Work, The Tender Should Consider For The Following, Irrespective Whether It Has Been Mentioned Or Not In The Description Of The Item Without Any Extra Claim/Payment:

1. All Paper Connected With The Tender, Including These Instruction, Schedule Of Items, Technical Specification, Drawing Etc Should Be Signed & Returned By The Tenderer To The Bank While Submitting The Tenders. Incomplete Tenders Are Liable For Rejection.
2. No Altercation Shall Be Made On The Tender Documents Including Schedule Of Items By The Tenderers. Any Discrepancy Noticed In The Tender Documents Shall Be Brought To The Notice Of The Concerned Official Of The Bank & Any Returned Instructions Received From The Bank As Reply Will Be Deemed To Have Been Incorporated Herein
3. The Tender Should Quote His Rates & Amounts For All Items Of The Tender Schedule. All The Rates & Amounts Quoted Should Be Written Both In Figures & Words & Where There Is A Difference Between The Two, The Rates Given In Words Will Be Taken As Authentic. Should There Be Any Discrepancy Between Unit Rate & Amount; Unit Rate Shall Be Considered As Correct One. All Arithmetical Mistakes Noticed During Verifications Of The Tender Shall Be Corrected.
4. All Entries In Tender Document Should Be In English & In Ink Or Typed. All Corrections Should Be Attested Under Full Signature Of The Contractor. Corrections Where Necessary Should Be Made By Scoring The Wrong Words/Figures & Attesting By Full Signature Of The Contractor. These Shall Not Be Erased/Overwritten/Corrected By Whitener.
5. Tender With Corrections And Or Overwriting If Not Authenticated Will Be Liable For Rejection. No Advice For Any Change In Rate Or Conditions After The Opening Of The Tender Will Be Entertained.
6. Rate Quoted Should Be For Specified Brand Only. Contractor Cannot Be Permitted For Use Of Non-Specified Brand. If Specified Brand Is Not Available, Equivalent Brand Can Be Used As Per Permission Of Bank's Engineer. For Civil & Interior Work, Specification Of Cpwd Shall Be Followed If There Is Any Doubt About Specification Of The Work Given In The Tender.
7. Incomplete Tender, Conditional Tenders, Tender Received After Prescribed Time & Date Through Courier/Post Or By Hand, Tenders Not Confirming To The Terms & Conditions Prescribed In The Tender Documents Shall Be Rejected.
8. Tender Sum Shall Be Calculated On Each Page And Carried Over To The Next Page. Tenders Shall Be Submitted In Original And Duplicate. Final Tender Sum Shall Be Written In Words Also. All Corrections, Overwriting Etc Shall Be Properly Authenticated. **Whitener Correction Pen** Shall Not Be Used Under Any Circumstance Because Your Tender May Be Cancelled If Desired By Bank. The Decision Of Bank Shall Be Final And Binding On Contract. No Correspondence Shall Be Entertained By Bank.
9. **Caution Note: Please Note That The Contractor Quoting Abnormally Low / Erratic Rates May Be Asked To Submit Rate Analysis Or Performance Guarantee Or In The Form Of Bank Guarantee Or Both Issued By Any Scheduled Bank As Per Draft Supplied By The Bank, Within A Period Of One Week Before Award The Work. The Amount Of Said Bank Guarantee Shall Be Equal To 110% Of The Value Difference Of Total Value Of The Items Marked As Alr At The Time Of Vetting And The Proposed Estimated Cost Of The Same Items As Mentioned In Nit. Alternatively, The Contractor May Choose To Deposit The Said Amount In The Form Of Stdr/Fdr In Favour Of Deputy Emd In Favour Of The R.M, Of Aforesaid Address Or Simply Sbi, Kolkata, Preferably Issued By The Sbi. This Bank Guarantee/Stdr/Fdr Will Be Treated As An Additional Security Deposit For Due Fulfillment Of Contract And Will Be Retained By The Sbi For Entire Completion Period Of The Project. The Contractor Shall Undertake Not To Cancel/Withdraw The**

Said Bank Guarantee/Std. In Case Contractor Fails To Undertake The Job Within Stipulated Time Or Leave The Same Incomplete Or Carryout Substandard Job, The Bank Will Be At Liberty To Forfeit The Said Initial Security Deposit And Additional Security Deposit By Invoking The Bank Guarantee/En-Cashing The Std/Fdr.

10. The Work Has To Carry Out Strictly According To The Conditions Stipulated In Tender Consisting The Following Documents & Most Workmen Like Manner.

- a) Notice Inviting Tender B) General Conditions Of Contract C) Instructions To Tenderer
d) Technical Specification E) Special Conditions Of Contract F) Drawings**

Declaration

We Confirm That We Are Submitting Our Tender Duly Filed In & Rates Have Been Quoted After Thorough Study Of Site Conditions & Above Stated Contract Documents Issued By The Bank. I/We Hereby Accord Our Unqualified Consent & Agreement To The Said Conditions. .

Place

Date:

Signature Of Contractor

D.Technical Specifications.

I) Specification Guide For Execution Of Interior Work

1. Modular Grid Ceiling: Providing & Fixing Of Modular Grid Ceiling At All Heights Of 600x600x15 M Of Armstrong Mineral Fibre Acoustical Suspended Ceiling System/Any Equivalent Make With (Micro Look) Edge Tiles Product Code H-1893m With Armstrong Silhouette B/R (Black Reveal) Exposed Grid. The Tiles Should Have Humidity Resistance (Rh) Of 99%, Nrc 0.50, Light Reflectance >85%, Thermal Conductivity $K = 0.052-0.057w/Mk$, Colour White, Fire Performance Class 0/Class 1 (Bs - 476) In Module Size Of 600mm X 600mm X 15mm With Bio Block Coating On The Face Of The Tile, Suitable For Green Building Application, With Recycled Content Of 58%. The Tile Shall Be Laid On Armstrong Silhouette Profile Grid System With 15mm White Flanges Incorporating A 6mm Central Reveal In Black Colour And With A Web Height Of 38mm And A Load Carrying Capacity Of Minimum 15 Kgs/M2. Silhouette, Main Runners & Cross Tees To Have Mitred Ends & "Birdsmouth" Notches To Provide Mitred Cruciform Junctions. The T Sections Have A Galvanizing Of 120 Grams Per M2 & Passed Through 500 Hrs Of Salt Test. The Tile & Grid System Used Together Should Carry A 15 Year Warrantee.

Installation: To Comprise Main Runner Spaced At 1200mm Centre Securely Fixed To The Structural Soffit Using Armstrong Suspension System (Specifications Below) At 1200mm Maximum Centre & Not More Than 150mm From Spliced Joints. The First/Last Armstrong Suspension System At The End Of Each Main Runner Should Not Be Greater Than 600mm From The Adjacent Wall. 1200mm Long Cross Tees To Be Interlocked Between Main Runners At 600mm Centre To Form 1200 X 600 Mm Module. Cut Cross Tees Longer Than 600mm Require Independent Support. 600 X 600mm Modules To Be Formed By Fitting 600mm Long Cross Tees Centrally Between The 1200 Mm Cross Tees. The 1200mm Cross Tees To Have Central "Birdsmouth" Notches To Facilitate Fitting Of 600mm Cross Tees. Perimeter Trim To Be Armstrong Shadow Wall Molding (Dimensions: 19x7x7x14mm), Secured To Walls At 450 Mm Maximum Centers.

Armstrong/ Equivalent Suspension System Accessories Manufactured And Supplied By Armstrong World Industries Consisting Of M6 Anchor Fasteners With Vertical Hangers Made Of Galvanised Steel Of Size 26 X 26 X 25 X 1.2mm With A Galvanised Thickness Of 80gsm, A Pre Straightened Hanger Wire Of Dia – 2.68 Mm Of 1.83 M Length., Thickness Of 80gsm And A Tensile Strength Of 344-413 Mpa, Along With Adjustable Hook Clips Of 0.8mm Thick, Galvanised Spring Steel For 2.68 Mm With A Minimum Pull Strength Of 110 Kg. The Adjustable Clip Also Consists Of A 3.5 Mm Aquiline Wire To Be Used With The Main Runner.

Rate: Rate Shall Be Include All The Items Mentioned Above/Elsewhere In The Contract Including All Labour, Material, Equipments & The Hardware As Required In Complete All Respect As Per Drawing As Directed. The Area Of The Ceiling Where Full Tile Size Light Fixture Are Installed, Will Not Be Deducted From The Total Quantity Executed , However The Cost Of Tiles Where The Full Tile Size Fitting Are Installed Will Be Deducted As Per The Market Rate.

The Work Shall Be Executed Through Authorized Applicator Of Approved Make. The Contractor Has To Submit

The Certificate From The Company For The Use Of Approved Make Sections & Boards Along With The Final Bill

Plain Gypsum Board False Ceiling:

Basic Frame Work: Providing And Fixing In Position Dropped Ceiling In Two Levels Including Vertical Surfaces In Between Two Level Of Ceiling Surface By Using Standard Company Sections (Gypsteel Ultra) Which Includes Providing & Fixing G.I. Perimeter Channels Of Sixe 0.5 Mm Thick Having One Flange Of 20 Mm & Another Flange Of Nylon Sleeves & Screws , At 610 Mm Centers, Then Suspending G.I. Intermediate Channels Of Size 45 Mm ,0.9 Mm Thick With Two Flanges Of 15 Mm Each From Soffit At 1220 Mm Centers With Ceiling Angle Of Width 25mm X10 Mm X 0.5 Mm Thick Fixed To The Soffit With G.I. Cleat & Steel Expansion Fastener Ceiling Section Of 0.5 Mm Thickness Having Knurled Web Of 51.5 Mm & Two Flanges Of 26 Mm Each With Lips Of 10.5 Mm Area Then Fixed To The Intermediate Channel With The Help Of Connecting Clips & In Direction Perpendicular To The Intermediate Channel At 457 Mm C/C.

Finished: 12.5 Mm Tapered Edged Gyp Board (Confirming To Is-2095-2011) Is Then Screw Fix To Ceiling Section With 25 Mm Drywall Screws At 230 Mm Centers, Screw Fixing Done Mechanically Either With Screwdriver Or Drilling Machine With Suitable Attachment . Standard Company Manufactured Sections (Gypsteel Ultra) Should Be Used For The Entire Framework .Finally The Board Of Size 6'x4' Are To Be Jointed And Finished So As To Have A Flush Look Which Includes Filling And Finishing The Tapered And Square Edges Of The Boards With Jointing Compound, Paper Tape Only As Per Recommended Practices Of **Saint-Gobin Gyproc India Ltd.**

General Note For The Item Rate Include: The Job Include Applying Two Or More Coats Of Acrylic Emulsion Paint In The Standard Procedure Of The Painting Job As Per The Shade & Finished Suggested By The Eic. The Cutouts For Variety Of Light Fixture & Other Equipments Etc & The Same Have To Be Made With The Frame Of Perimeter Channels Of Size 20 Mm X 27 Mm X 30 Mm X 0.5 Mm Thick Supported Suitably, No Extra Will Be Paid For This . Edge Bid Has To Be Used To Protect The Exposed Gypsum Core I.E. Cut Edges Of Opening For Light Fixtures. The Square Edge Joint Shall Be Filled With Jointing Compound & Paper Tape, Additional G.I. Or C.P. Teak Wood Support Shall Be Roveded For Fixing Of Verity Of Light Fixtures, A.C. Continues Grill ,Diffusers Etc. All Section Visible From A.C Grill Shall Be Painted In Black Colour. The Final Visible Plan & Elevation Area Will Be Considerd For The Measurement Purposed. The Work Shall Be Executed Through Authorized Applicator Of **Saint-Gobin Gyproc India Ltd. The Contractor Has To Submit The Certificate From The Gypsum India For The Use Of Company Sections (All) & Boards Along With The Final Bill. The Contractor Must Get The Worked Checked From The Company's Representative – On One Completion Of The Ceiling & Second On Completion Of Boarding Before Putting Top Coat. The Work Includes To The Shape Areas & Also The Coves As Per The Lay Out & Shall Be Measured In Sqmtr. Only.**

S.W.O Cash/Teller Counter:

Basic Structure: Made Out Of 19mm Thk. Isi Marked Phenol Bonded Bwp B/Board On Vertical Sides As Well As Horizontal Top Surfaces Having Work Top 900mm Deep, 750mm Height From Ffl. Each Counter Unit Is Approximately Of 1500mm Long Divided With Vertical Separator Having 1 No. Drawer Unit. The Work Top Is To Be Fabricated Out Of 19 Mm Thick Bwp Block Board Up To 700 Mm Depth To The Front, And Thereafter, A **Double Layer Of Flexi-Ply (12 Mm + 6 Mm Thick)**, Curved Downwards With A Turning Radius Of 75 Mm & Stiffened Properly To The Front Modesty Panel With Appropriate Wooden Sections, Is To Be Fixed With Necessary Fittings To The Block Board In Order To Have A Projection Of 200 Mm Towards Customer Side Beyond The Front Glass. The Front Modesty Panel Is To Be Made Out Of 19 Mm Bwp Block Board. Also, A 25 Mm X 25 Mm Groove At A Height Of 375 Mm From Ffl Along The Length Of The Front Modesty Panel Is To Be Provided To Facilitate Fixing Of Led Light. **Detail As Per Drawing Below. Drawer Unit:**

Below The Working Counter There Shall Be A Pedestal Unit Made Up Of 12 Mm Ply From Sides & 6 Mm Ply From Base Which **Consisting Of One Tea Tray & Two Drawers, The Top Would Be Of 200 Mm Depth & The Other Of Remaining Depth. All Drawers Are To Be Fitted With Sliding Telescopic Channels, Where The Slides Are To Be Fitted With Multi-Latch Of Approved Make. The Drawers Are To Be Provided With Auto Locks Of Approved Make & Powder-Coated "D" Handles. Also, The Bottom Of The Drawer Unit Is To Be Fixed To A 75 Mm X 37.5 Mm Teak Wood Framework With Polished Finishing. Inside Surface Of The Drawers Is To Be Painted With Synthetic Enamel Paint Of Approved Make Up To Matt Finishing.**

General: Each Counter Shall Be Provided With One Keyboard M S Trey Provided With Telescopic Channel, Cpu Trolley Of Innofit Or Any Other Approved Make, Pvc Wire Manager System With Necessary Cut Outs In The Structure & A Full Length Foot Rest Made Up Of Hard Wood 3"X1.5" Section Shall Be Provided At 4" Above F.L.

Finishes: The Entire Work Station Shall Be **1 Mm Bi-Colour Laminate** Finish On Horizontal & Vertical Surfaces In Two Colour Combination Of **Approved Make** On All Open External Sides. It Will Be In Balancing Laminate On Internal Surfaces Including Drawers. All Non Laminate Surface Of Counter, Pedestal Is Finished With Smooth Matching Melamine Polish. All Free Edges Of Block Board And Ply Duly Finished With Teak Wood Beading / Lipping As Directed.

Rate: Rate Shall Be Include All The Items Mentioned Above/Elsewhere In The Contract Including All Labour, Material, Equipments & The Hardware As Required In Complete All Respect As Per Drawing As Directed.



Blue Lacured Glass In Front / Side View Of Swo Counter.

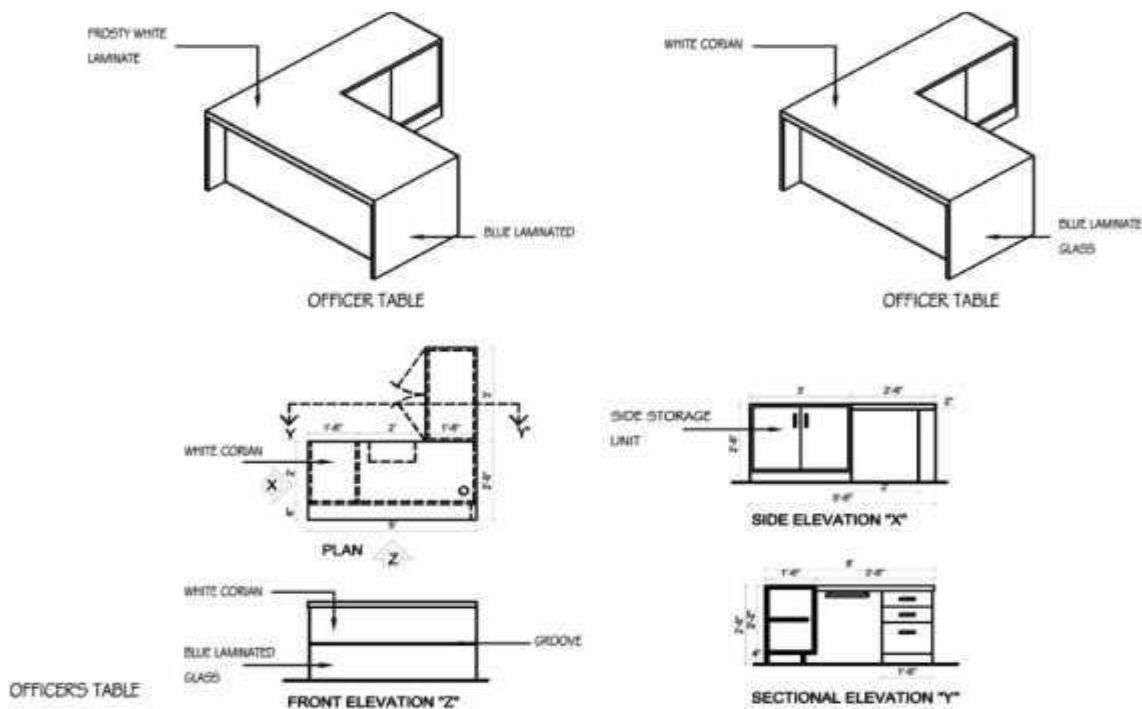

Officer/Staff Table Detail With Laminate Finish

NOTE : ALL WORK SHALL BE CARRIED OUT AS PER THE SPECIFICATION OF NEW UNIFORM LAYOUT, ELEVATION & COLOUR SCHEME OF SBI

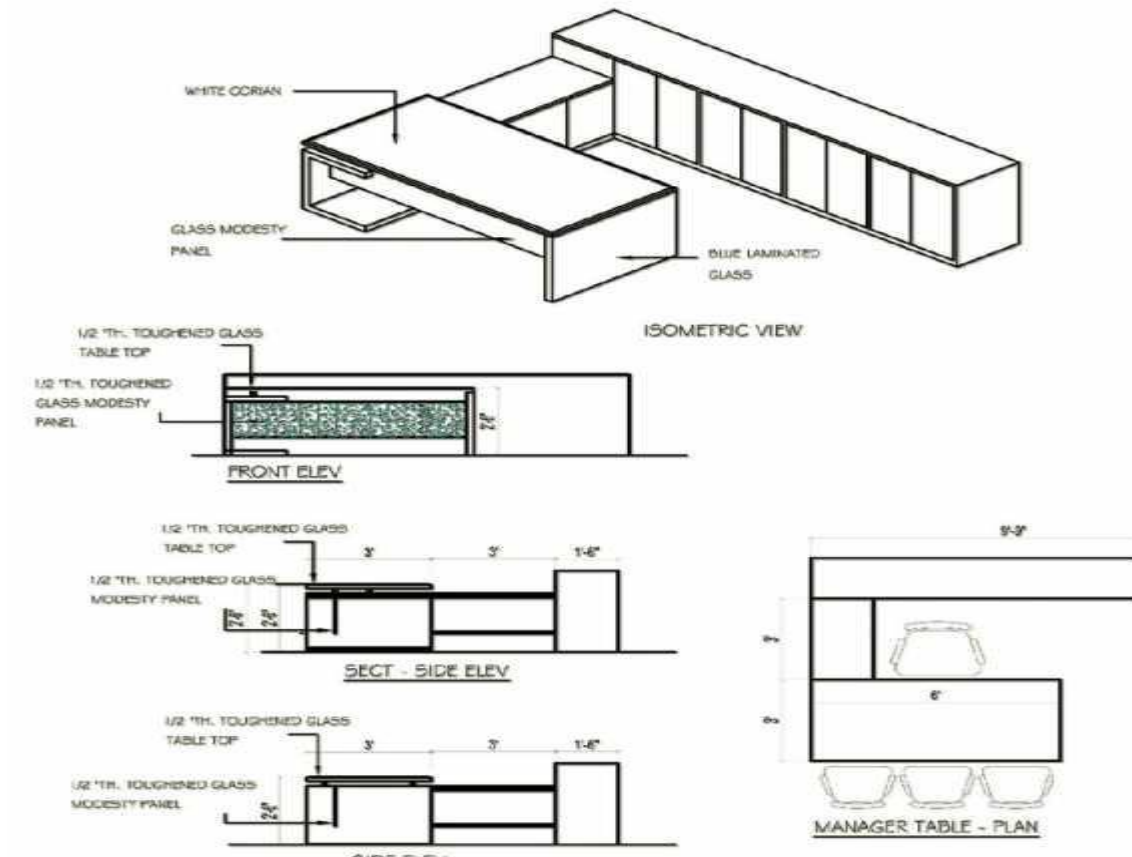

Agm Table With High-Gloss Laminate Finish

NOTE : ALL WORK SHALL BE CARRIED OUT AS PER THE SPECIFICATION OF NEW UNIFORM LAYOUT, ELEVATION & COLOUR SCHEME OF SBI

5.Free Standing Table:

Basic Structure: Fabricated Out Of 19mm Bwp B/Board With Tea Tray & Drawer Unit On one Side & Side Credenza On The Other Side Of The Table. The Table Shall Be Made Of 19mm Bwp Grade B/Board Front Top Sides & Front Modesty Panel With Dove-Tail Jointed Junctions. The Modesty Panel Is To Be Fixed To The Bottom Of Work Top Block Board 150 Mm Behind The Front Edge. A Glazing Is To Be Done On The Modesty Panel Fascia With 12 Mm Thick Machine Polished Transparent Toughened Glass, Fixed With Continuous Polished White Beech Wood Beading As Per Design. The Glass Is To Be Set In The Modesty Panel From A Height Of 200 Mm Up To 650 Mm From Ffl.

Detail As Per Above Drawing.

Drawer Unit: Each Table Shall Be Provided With A Drawer Unit Of 21" Deep 16" Wide Comprising Of 1 No. Tea Tray, **2 Numbers Of Sliding Drawers Each Of 150 Mm Depth And One Deep Drawer Of Remaining Depth After Leaving 3 Inch Skirting From Bottom Floor Level Fitted With Full Panel Telescopic Drawer Slides Of Approved Make With Individual Locking System, Powder Coated "D" Handle.** A Wooden Member Of Size Of 2 1/2"X3/4" Shall Be Fixed Between Each Drawer. Inside Surface Of Drawer Unit Should Be Painted With Matt Finished Synthetic Enamel Paint.

General: Each Counter Shall Be Provided With One Keyboard M S Trey Provided With Telescopic Channel, Cpu Trolley Of Innofit Or Any Other Approved Make, Pvc Wire Manager System With Necessary Cut Outs In The Structure & A Full Length Foot Rest Made Up Of Hard Wood 3"X1.5" Section Shall Be Provided At 4" Above Floor Level.

Finishes: The Work Top Is To Be Finished With [12 Mm Thick Solid Surface Material], Or, [1.5 Mm Thick High Gloss Laminate], Or, [4 Mm Thick Teak Wood Veneer With High Gloss Polyurethane Coating] Of Approved Shade & Make On The Surface, As Directed. It Will Be In Balancing Laminate On Internal Surfaces Including Drawers. All Non Laminate Surface Of Counter, Pedestal Is Finished With Smooth Matching Melamine Polish. All Free Edges Of Block Board And Ply Duly Finished With Teak Wood Beading / Lipping As Directed.

Rate: Rate Shall Be Include All The Items Mentioned Above/Elsewhere In The Contract Including All Labour, Material, Equipments & The Hardware As Required In Complete All Respect As Per Drawing As Directed.

Full Height Solid/Glazed Partition (64mm Thickness):

Basic Structure: It Shall Be Made From Internal Frame Of Size 50mm X 50 Mm X 1.6 Mm Hollow Aluminum Square Tube Placed 600mm C/C Both Vertically And Horizontally, Fixed By Means Of Aluminum Angle Of 25x25x25 Mm Size For Proper Fixity. The Entire Aluminum Frame Work Shall Be Covered With 6 Mm Thick Ply On Both Sides. All Open Sides Of The Frame Work Shall Be Covered With 12mm Thick Ply To Cover The Entire Thickness Of Partition. The Upper Portion Of The Partitions Will Have 6/8 Mm Thick Clear Glass Required As Per Size Of Glass, Fixed With 10 Mm Thick (F.S) Wooden Molding With Suggested Grooves To Cover The Full Thickness Of Partition .The Lower Portion Of Partition Up To 3ft Will Have Internal Frame Work As Detail In Above. The Same Shall Be

Then Covered By 6 Mm Thick Ply Panels To Get Flush Type Partition. A Wooden Beading Of 2 ½"X1/2" Shall Be Provided As All Open Thickness Of The Partition For Door Opening & Fixing Of Glass. The Hinge Side Aluminum Frame Shall Be Fixed With Wooden Section. In Case Of Solid Partition, The Entire Surface Will Be Finished With Opaque Finished With Ply & Laminate Excluding The Glass With Same Section As Mentioned Here.

General: All The Gaps Either Vertical Or Horizontal Shall Be Filled Properly With Ideal Material. All **The** Vertical Members Of The Partitions Shall Be Carefully Inserted/Fixed In The Floor (Without Damaging The Floors) & Also Shall Be Fixed To The Structural Ceiling For Proper Strength. Necessary Provision Shall Be Made In The Partition For Electrical Conduits, Switch Boards, Ac Drain Lines & Ac's Etc As Required. The Common Member Of Partition & Frame Of Door Will Be Consider In The Item Of Partitions **Only Below The Ceiling Area Will Be Consider For Measurement Purpose, However The Partitions Shall Be Raised 3" Above The False Ceiling Level For Fixity For The Ceiling & Also All Vertical Member Shall Be Taken Up To The Slab/Beam Bottom.**

Finishes: All The External Ply Wood Components Shall Be Finished With 1 Mm Thick Laminate In Two Color Combination Laminate Finish Of Approved Shade On Both Sides & Also Thickness Of The Partition. All External Wooden Members Shall Be Melamine Matt Polish Finish.

Rate: Rate Shall Be Include All The Items Mentioned Above/Elsewhere In The Contract Including All Labour, Material, Equipments & The Hardware As Required In Complete All Respect As Per Drawing As Directed.

Low Height Solid/Glazed Partition (64mm Thickness):

Basic Structure: It Shall Be Made From Internal Frame Of Size 50mm X 25 Mm X 1.6 Mm Hollow Aluminum Square Tube Placed 600mm C/C Both Vertically And Horizontally, Fixed By Means Of Aluminum Angle Of 25x25x25 Mm Size For Proper Fixity. The Entire Aluminum Frame Work Shall Be Covered With 6 Mm Thick Ply On Both Sides. All Open Sides Of The Frame Work Shall Be Covered With 12mm Thick Ply To Cover The Entire Thickness Of Partition. The Upper Portion Of The Partitions Above 3' Level Have 12 Mm Thick Clear Glass With All Open Edge Polished & Necessary Cutouts As Directed, Fixed With Glass Bracket. In Case Of Solid Partition, The Entire Surface Will Be Finished With Opaque Finished With Ply & Laminate Excluding The Glass With Same Section As Mentioned Here.

General: All The Gaps Either Vertical Or Horizontal Shall Be Filled Properly With Ideal Material. All The Vertical Members Of The Partitions Shall Be Carefully Inserted/Fixed In The Floor (Without Damaging The Floors) For Proper Strength. Necessary Provision Shall Be Made In The Partition For Electrical Conduits, Switch Boards, Ac Drain Lines & Ac's Etc As Required. The Common Member Of Partition & Frame **Of** Door Will Be Considered In The Item Of Partitions. To The Shape On Site Measurement Will Be Considered. The Partitions Will Have A Cutout In Glass For Tray For Voucher Movement Between Counter.

Finishes: All The External Ply Wood Components Shall Be Finished With 1 Mm Thick Laminate In Two Color Combination Laminate Finish Of Approved Shade On Both Sides & Also Thickness Of The Partition. All External Wooden Members Shall Be Melamine Matt Polish Finish.

Rate: Rate Shall Be Include All The Items Mentioned Above/Elsewhere In The Contract Including All Labour, Material, Equipments & The Hardware As Required In Complete All Respect As Per Drawing As Directed.

8.Storage Cabinets/Credenza: General Purpose Of Various Sizes & Heights As Directed

A) Filling Cabinets With Sliding Shutter: It Shall Be Made Of 19 Mm Thick Board On All Five Sides While Back Surface Shall Be Made Of 6 Mm Ply. The Storage Space Will Be Separated By 19 Mm Block Board At Suitable Location So That Each Block Will Be 500 To 750 Mm Equal Parts. The Sliding Shutter Shall Be Provided With Godrej Lock, Ebco/Hettich To Be Fitted For Bottom Running Sliding Doors Side Line 56 Without Silent System Assembly & Handle Of Standard Quality To Be Flush With Ply/Blockboard.The Exposed Surface Shall Be Laminate With 1 Mm Thick Laminate Of Approved Colour. The Inside Surface Shall Be Finished With Putty & Enamel Paint Over A Coat Of Primer. The Bottom Of The Cabinet Is To Be Fixed To A 3" X 1.5" Teak Wood Framework Polish Finished & Free Edges Of Block Board Shall Have Polished Teak Wood Half Round Moulds Out

Rate: Quoted Rates Shall Include Cost Of All Material, Labour & Necessary Hardware Viz. Handles, Locks With Of 20x20 Mm Section.Key In Duplicate, Approved Sliding Channel Of Ebco Make/Equivalent Etc Complete In All Respects.

B) Filling Cabinets With Openable Shutter : Low Height/Full Height As Per Drawing:

Providing And Placing In Position Storage Units Fabricated Out Of 19mm Thick Bwp Block Board On All Sides, Backing

And Separators Will Be Of 6mm Thick Bwp Ply, Shelves Will Be Of 19mm Thick Bwp Solid Ply. There Will Be 19mm Thk. Ply Shutters Of Full Length With Powder Coating Louvers Matching With The Color Of The Laminate For Air Circulation Fixed With Auto- Hinges At Approx. 3ft.The Top, Sides, Shutter Front And Back Sides (If Exposed) To Be Finished With 1mm Thick Bi-Colour Laminate With Necessary Grooves And The Exposed Edges Of Block Board Should Be Finished With 6mm T.W. Lipping. There Should Also Be A 75 X 12 Mm T.W. Skirting With Grooves As Per Design Polished In Matching Tone. Inside Of The Unit Will Be Painted With Putty & Synthetic Enamel Paint Over A Coat Of Approved Primer.

Rate: Quoted Rates Shall Include Cost Of All Material, Labour & Necessary Hardware Viz. Handles, Multipurpose Locks With Key In Duplicate, S.S Hinges, Magnetic Catches, D" Type Steel Matt Finish Metal Handles Etc Complete In All Respects.

9. Column/Wall Paneling: Basic Structure: Providing & Fixing Of Wall Paneling/Column Encasing For All Heights By Putting Aluminum Frame Work Of Size 37.5x25x1.2 Mm Thick At Suggested Interval ,Fixed With 1"X1"X1" Al. Angle For Proper Fixity (Not More Than 2ft On Both Direction, Covered With 6mm Thick Ply Fixed On Entire Frame Work .The Paneling Should Have Necessary Cutouts For Electrical Conduit/Switch Boards/Boxes. The Entire Paneling Shall Be Constructed In Complete Line & Level By Putting Necessary Packing As Per The Site Condition.

For Wall/Column Veneer Paneling With 37.5 Mm X 25 Mm X 1.5mm Hollow Aluminum Square Tube Frame Work Placed At 450mm / 600 Mm C/C As Per Site Condition Screwed To The Wall And Finished With 4mm Veneer Of Approved Shade & Brand Duly Polished Over 12 Mm Bwr Ply Complete.

Finishes: All The External Plywood Components Of Entire Paneling Shall Be Finished With 1mm Thick 2 Color Combination Laminate Finish. Skirting Of 100mm High X 12 Mm Thick Polished Teak Wood Or Steam Beech Wood Skirting With Nc Lacquer In Matt Finish. For Veneer Paneling

Rates: Quoted Rates Shall Include All Necessary Materials, Accessories And Labour And Also Allow Provisions For Electrical/Telephone/Computer Wiring Conduits & Switch Boxes Etc. Complete With Necessary Jacking /Thickening Of Panels To Accommodate Conduits/ Switch Box Etc As Directed.

10.System Table In Server Room: The Unit Will Be A Running Table Made Of 19mm Thick Block Board/Plywood Of Sides & Top, Back Out Of 6mm Bwp Ply Having Width 750 Mm (W) X750mm (H). At Each 1000 To 1200mm Length, The Unit Shall Have One Tea Tray & One Drawer And One Cupboard Provided With Telescopic Channel. Measurement Shall Be In Running Meter Length. Necessary Vertical Support (19mm Block Board/Ply) Shall Be Provided For Drawers As Specified Elsewhere In The Tender.

General/Finishes: There Should Be Provision For 2 Numbers Keyboard & Cable Manager System With Necessary Cutouts In Top Surface. The Entire Counter Type Workstation Shall Be 1 Mm Thick Laminate Finish Of 2 Color Combination On External Sides & In Balancing Laminate Finish On Internal Surface Including The Drawers. All Free. Edges Should Be Beaded Properly & Members Shall Be Melamine Matt Polish Finish.

Rate: Rate Shall Be Include All The Items Mentioned Above/Elsewhere In The Contract Including All Labour, Material, Equipments & The Hardware As Required In Complete All Respect As Per Drawing As Directed.

11.Side Unit/Credenza:

The Side Unit Shall Be Made Of 19mm Thick Bwp Grade Block Board For Sides, Top, Bottom , Divider Shelve Back With 6 Mm Bwr Ply. The Unit Is Having The Size Of 400mm X 750mm & Approximate Length Of 1 Mtr. Consisting Of 1 No. Of Drawer & Cupboard Of Length 21" & Rest Will Be Made As Shelve With An Intermediate 19 Mm Block Board At Center. All Exposed Portions Like Top, Side & Shutter To Be Finished With 1mm Thick Decorative Laminate & Inner Surface With Mat Finished Enamel Paint. The Rate Also Inclusive Of All Approved Fittings Like Lock, Handle, Hinges & Telescopic Channels Etc Complete In All Respects As Directed.

Flush Door:

It Shall Be Made From 35 Mm Thick Factory Made Shutter Of Century/Mayor / Mars /Approved Isi Consisting Of Solid Core Block Of Board Bonded With Phenol Phormaldehyde Synthetic Resin Conforming To Is: 848 And Finished On Both Faces With Teakwood Veneering Of 3.5 Mm Thick, Including Providing And Fixing 'T' Type Second Class Teakwood Perimeter Beading Fixed By Means Of Approved Quality Neoprene Based Adhesive And Nailing @ 300 Mm Max. In Case Of Glazed Door, The Same Will Be Made Of With Above Specification With 8 Mm Thick Float Glass From 3ft Finished Floor Level Up To 6" Below The Door Pasted With Etching As Per Design & Finished With 1.0mm Thk. Approved Colour Laminate Sheet Of Approved Make On Both Sides. General: The Door Shall Be Fixed With All Necessary Hardware Fittings Such As 125mm Long S.S. Butt Hinges [For Each Shutter] (Vertical Spacing Not Exceeding 600mm),Door Stopper, 6lever Godrej Mortise Door Lock Finishing Etc. All Conforming To Is : 2202. All Free Edges Shall Be Duly Polished With 3 Coats Of Lacquer Melamine And Fixed To The Partition Frame.

Rate: Rate Shall Be Include All The Items Mentioned Above/Elsewhere In The Contract Including All Labour, Material, Equipments & The Hardware As Required In Complete All Respect As Per Drawing As Directed.

ii) List Of Approved Brand And/Or Manufacturer For Interior Furnishing Work.

Annexure-I

Sr. No.	Description	Name Of The Manufacturer
1	A) Locks	Godrej / Ebco / Hettich
	B) Floor Spring, Patch Fittings C)Door Closer/Stoper	Everite, Dorma/ Godrej/Innofit//Egl/Ebco Door Set/Ebco/Ozone Ss Mat Finished-Push Type Only
2.	Night Latch	Godrej / Doorset / Europa Of S.S Brush Finished
3.	Glazing	Aasahi , Tata, Modi Guard Or Saintgobain, Sure Safe Or Equivalent As Approved By Eic
4.	Ply Wood (Bwr Is 303) / Block Board Bwp (Is 1659)	Century / Green / Sylvan / Austin Or Equivalent As Approved By Bank's Engineer.
5	Laminate-1mm Thickness	Century/ Green/ Royaltocuh/ Mica
6.	Wood Veneer	Century/ Green/Euro
7.	Mineral Fiber Board Ceiling	Armstrong /Usg Or Equivalent As Approved By Eic
8.	Gyp Board False Ceiling	India Gypsum Ltd./Usg/ Armstrong
9	Handles, Tower Bolts, Drawer Slide Channels Telescopic,	Ebco/Hettich /Innofit/Equivalent Premium Quality Bottom Mounted
10.	M S Key Board Trey Without Mouse	Ebco/Hettich/Innofit /Featherlite
11.	Vertical Blinds	Vista/Egl Or Equivalent.
12.	Cpu Trolley	Ebco/Hettich/Innofit/Featherlite
13.	Chemical Adhesive	Pidlite/Quickfix/ Latticrete
14.	Motorized/ Manually Operated Blind	Vista Levolor/ Mac/ Hunter Douglass
15.	Aluminum Composite Panel	Aludecor /Alex /Alubond Or Alstrong
16.	Adhesive	Movicol / Fevicol / Aralditeicol / Araldite.
17.	Vinyl Flooring	Regent Winner/Armstrong/Krishna
18.	Aluminum Tubular Section:	Minimum 1.5 Mm Thick Of Jindal/Hindalco/Indal(2"X1"/1"X1")
19.	Melamine	Asian Paint,Shalimar,Ici

N.B: Whenever Decorative Ply Wood Veneer/ Laminate Is Specified, It Must Be Ensured That The Specified Veneer Or Laminate Shall Be Matching Veneer/Laminate As Directed. The Grains Of Veneer & The Colors Of Laminate Are As Per The Approved Shade. Bank Have Right To Reject If Above Specification Is Not Adhered To. Whenever Polishing Is Specified, It Should Be High Quality Melamine Finished Sprayed Or Hand Applied To High Gloss Or Matt As Directed At Site & Strictly Be Carried Out As Per Manufactured Specification

ii) List Of Approved Brand And/Or Manufacturer Civil Work.

1	Sanitary Fitting	Cera/ Parryware/ Hinhdware/ Nirali
2.A	Oil & Cement Paints All Type	Berger /Asian /Dulox
B	Wall Putty	Birla White/ J.K White As Approved By Eic
3.	Glazing	Tata, Modi Guard Or Saintgobain, Sure-Safe

4	Cement	Ultratech/ Acc/Lafarge
5	Sand/Aggregates	Locally Available Good Quality Sand (Equivalent To Pankur Sand Quality) & Hard Aggregates Approved By Eic
6	Ceramic Tiles	Johnson / Nitco/Rak As Approved By Eic
7	Double Glazed Vitrified Tiles	Somany/ Kajaria/ Nitco/Jhohnson/Rak
8.	Texture Paint	Berger /Asian /Dulux
9.	Upvc Windows	
10.	Vertical Blinds	Vista/Levolor/ Mac/Equivalent
11.	Reinforcement	Sail/Tata Steel

The Challan Of The Materials Or The Invoice Or The Certificate From Concerned Companies Will Be Required To Be Submitted If Demanded By Bank's Engineer At The Time Of Submission Of The Final Bill. If The Approved Brands Mentioned As Mentioned In The Item Are Not Available Or Requisite Shade/ Quality Is Not Available, Other Brand As Approved By The Bank's Engineer Only To Be Used For The Work. Decision Of Bank's Engineer Shall Be Final And Binding On The Contract.

Caution: 1) At The Time Of Handing Over The Site, If Any Scratches Or Decoration Of Above Specified Material As Used Is Being Observed, Then Bank Shall Have The Right To Insist Application Of Another Coat Or Replacement Of The Material As Required.

2) All The Hardware Shall Be Of High Quality Brass Oxidizing/ Polished Brass Fittings Finish Of Approved Make & Confirming To Is Specification. Sample Shall Be Shown In Advance & Approval Obtained Before Procurement.

3) **All Materials Specified Above Shall Be Used Only After Quality Check/Inspection/Approved By Eic.**

E.Special Condition Of Contract

1. **Setting Out The Work:** A)The Contractor Shall Set Out The Work And Shall Be Responsible For The True And Perfect Setting Out Of The Same And For The Correctness Of The Positions, Levels, Dimensions, And Alignment Of All Parts Thereof And Get It Approved By The Consultant/ Bank's Engineer Before Proceeding With The Work. If At Any Time Any Error In This Respect Shall Appear During The Progress Of The Works, Irrespective Of The Fact That The Layout Had Been Approved By The Consultant/ Bank's Engineer The Contractor Shall Be Responsible For The Same And Shall At His Own Expenses Rectify Such Error, If So, Required To Satisfaction Of The Sbi.
 - b) The Dimension Provided In The Schedule As Well As In The Drawing Are Likely To Vary Slightly According To The Size & Space Available In The Premise Area Where They Are To Be Provided Or Placed, Bank Have The Right To Slightly Modified The Dimensions Of The Items To Suit The Site & No Claim Therefore Shall Be Made By The Contractor.
2. **Protection Of Works And Property:** The Contractor Shall Continuously Maintain Adequate Protection, Of All His Work From Damage And Shall Protect The Sbi's Properties From Injury Or Loss Arising In Connection With Contract. He Shall Make Good Any Such Damage, Injury, Loss Due To His Fault Or Negligence Except Which Are Due To Causes Beyond His Control.
3. **Inspection Of Work:** The Bank's Engineer/Consultant Or Their Representatives Shall At All Reasonable Time Have Free Access To The Work Site And/Or To The Workshop, Factories Or Other Places Where Materials Are Lying Or

From Where They Are Obtained And The Contractor Shall Give Every Facility For Inspection And Examination And Test Of The Materials And Workmanship.

4. **Quality Of Materials, Workmanship & Test:** All Materials And Workmanship Shall Be Best Of The Respective Kinds Described In The Contract And In Accordance With Bank's Engineer/Consultant Instructions And Shall Be Subject From Time To Time To Such Tests As The Bank's Engineer/Consultant May Direct At The Place Of Manufacture Or Fabrication Or On The Site Or An Approved Testing Laboratory. The Contractor Shall Provide Such Assistance, Instruments, Machinery, Labour And Materials As Are Normally Required For Examining Measuring Sampling And Testing Any Material Or Part Of The Work Before/After Incorporation In The Work For Testing As May Be Selected And Required By The Architect/Consultant.
5. **Obtaining Information Related To Execution Of Work:** No Claim By The Contractor For Additional Payment Shall Be Entertained Which Is Consequent Upon Failure On His Part To Obtain Correct Information As To Any Matter Affecting The Execution Of The Work Nor Any Misunderstanding Or The Obtaining Incorrect Information Or The Failure To Obtain Correct Information Relieve Him From Any Risks Or From The Entire Responsibility For The Fulfillment Of Contract.
6. **Works To Be Measured:** The Bank's Engineer/Consultant May From Time To Time Intimate To The Contractor That He Required The Work To Be Measured And The Contractor Shall Forthwith Attend Or Send A Qualified Representative To Assist The Them In Taking Such Measurements And Calculation And To Furnish All Particulars Or To Give All Assistance Required By Any Of Them. The Contractor Or His Authorized Representative Shall Sign All The Pages Of The Measurement Book In Which The Measurements Have Been Recorded In Token Of His Acceptance All Authorized Extra Work, Omissions And All Variations Made Shall Be Included In Such Measurements.
7. **Bill Submission Format:** The Bill Shall Be As Per Tender Specification As Detailed Below Along With Detail Measurement Sheet. Bill Will Not Be Accepted If Detail Calculation Sheet Of The Quantity Executed At Site Is Not Being Attached. If Required Then The Contractor May Be Ask To Submit The Manufacturing Certificate In Due Course Of Bill Checking Period

Si. No	Description	Unit	Ted Rate	Ten Qty	Act Qty (L/B/D)	Ted Amount	Act Amount
--------	-------------	------	----------	---------	-----------------	------------	------------

Declaration

I/We Hereby Declare That I/We Have Read The Above Terms And Conditions /Instructions Carefully And Fully Understood And Will Abide By The Same.

Signature Of The Vendor With Seal

Place :

Date :

NOTE: PLEASE CONTACT CONCERNED CIVIL ENGINEER FOR ANY TECHNICAL QUERY RELATED TO THIS PROJECT.